

**GUIDANCE NOTE FOR ALTON DWARF WALL GREENHOUSES.**

**FOOTINGS**

CONCRETE STRIP FOOTINGS SHOULD BE A MINIMUM OF 400mm WIDE X 200mm DEEP. IF THE SITE IS ON MADE UP GROUND IT IS IMPORTANT THAT THE FOOTINGS ARE CUT INTO THE COMPACTED GROUND BELOW. WHERE THE GROUND IS LIABLE TO MOVEMENT SUCH AS HEAVY CLAY OR LOOSE SANDY SOIL REINFORCING SHOULD BE ADDED TO THE CONCRETE FOOTINGS.

**WALLS**

IT IS MOST IMPORTANT THAT THE BRICKWORK IS IN ACCORDANCE WITH THE DIMENSIONS PROVIDED AND IS SQUARE, LEVEL AND UPRIGHT, THE DIAGONAL MEASUREMENTS SHOULD BE EQUAL.

WALLS CAN BE EITHER DOUBLE OR SINGLE SKIN.

THE TOP COURSE OF BRICKS SHOULD BE LAID FROG DOWN. IF ENGINEERING BRICKS ARE USED FOR THE TOP COURSE PLEASE ENSURE THEY ARE SOLID NOT CELLULAR (WITH HOLES THROUGH THEM) OR FIXING DOWN OF THE GREENHOUSE WILL BE A PROBLEM. BRICKS SHOULD BE A GOOD QUALITY STOCK BRICK, SAND FACED FLETTON TYPE BRICKS ARE NOT SUITABLE.

**GABLE DOOR OPENING**

THE OPENING FOR THE DOORWAY AND THE HEIGHT TO THE TOP OF THE WALL FROM THE THRESHOLD LEVEL REQUIRE THE HIGHEST ACCURACY AND ARE MOST IMPORTANT SO THAT THE DOOR FITS THE APERTURE CORRECTLY.

**A TIMBER FORMER SHOULD BE USED TO CONSTRUCT THE DOOR OPENING**, EITHER MAKE A FRAME OR CUT A PEICE OF PLYWOOD (THIS SHOULD BE PERFECTLY SQUARE!) TO THE FOLLOWING DIMENSIONS **817MM WIDE X 750MM HIGH**.

PLEASE ALSO BE AWARE THAT THE DOOR OPENS INWARDS AND THEREFORE THE FOUNDATIONS NEED TO AVOID ANY DOOR INTERFERENCE.

IF SINGLE SKIN WALLS ARE USED THEN PIERS SHOULD BE FORMED AT THE DOOR OPENING.

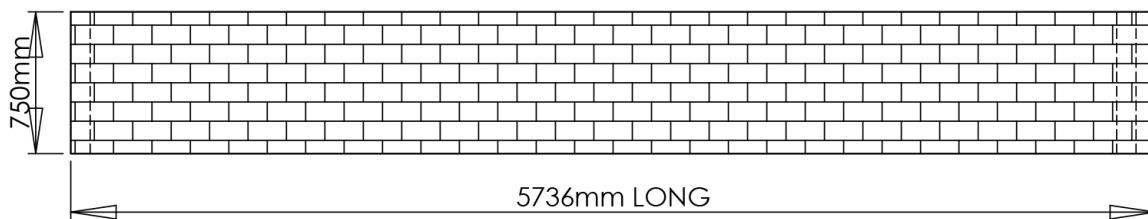
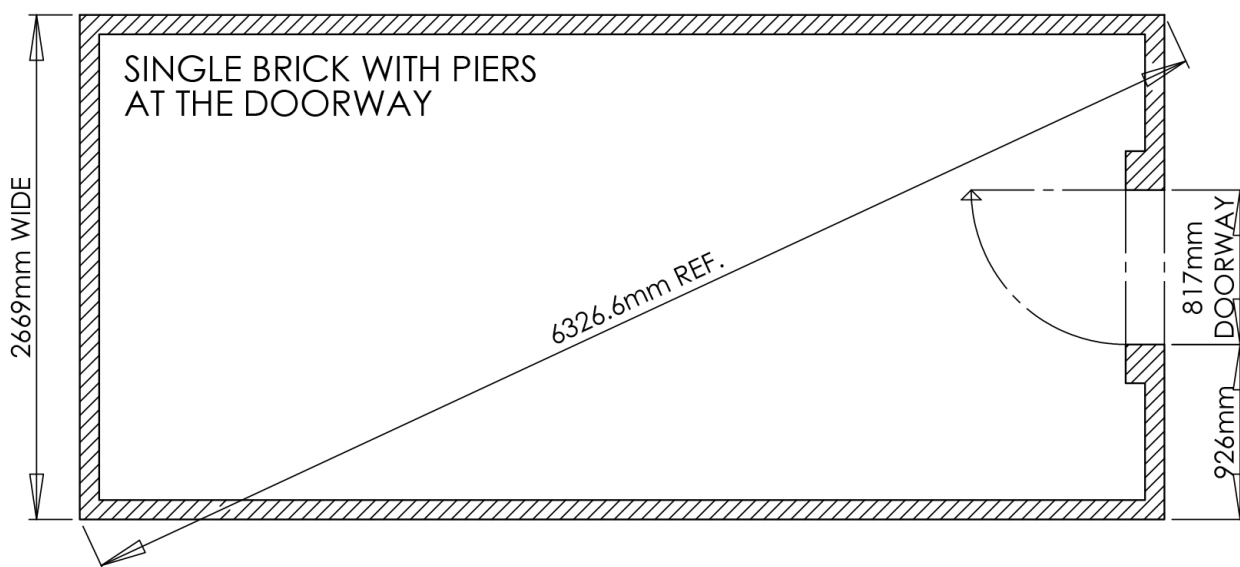

UNLESS OTHERWISE SPECIFIED:  
DIMENSIONS ARE IN MILLIMETERS  
ALL RADIUS 0.50MM

Part No:  
NA

Title:  
Alton Victorian Dwarf wall Plan 8x18

A4

Section No: NA

REVISION

DATE 30/03/2021